

2 Bedroom Floor Plan

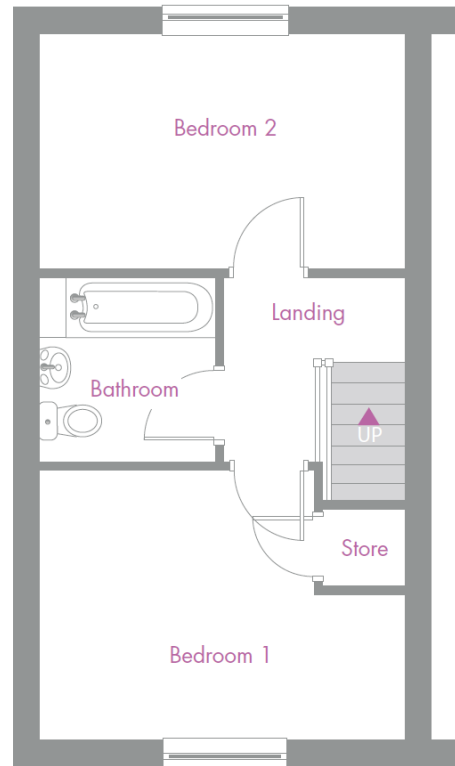
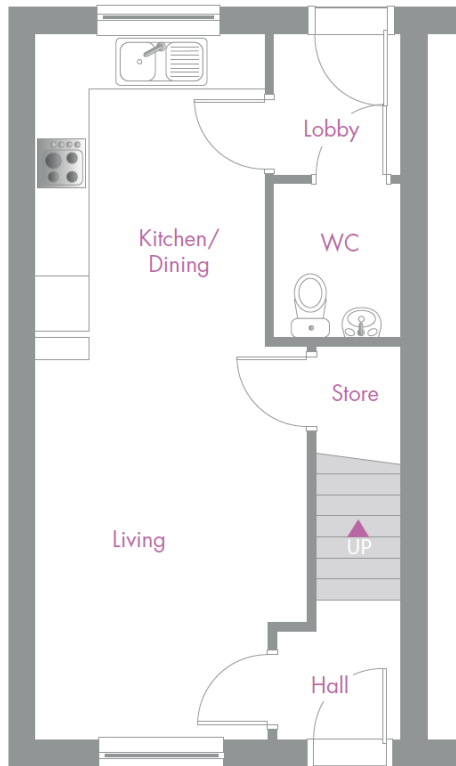

2 Bedroom Semi-detached House

Kitchen/dining	3.50m x 2.69m	11'8" x 8'10"
Living	4.42m x 3.18m	14'6" x 10'5"
Bedroom 1	4.24m x 3.14m	13'11" x 10'4"
Bedroom 2	4.24m x 2.75m	13'11" x 9'0"
Bathroom	2.18m x 2.04m	7'2" x 6'8"

Total Floor Area: 68.00m² - 732.00 sq.ft

Please note: All dimensions are taken from the widest and longest points of each room. Some properties will be 'handed' (mirror image) to floorplan shown.