

THE IVY 2 Bedroom Terrace House

Dracan Village at Drakelow Park, Burton on Trent, DE15 9UA

Plots 374, 375, 376, 478, 479, 480, 490, 491, 492, 493, 530, 531, 532, 533, 541, 542, 543, 548 & 549



CGI Drawing of a typical Terrace plot

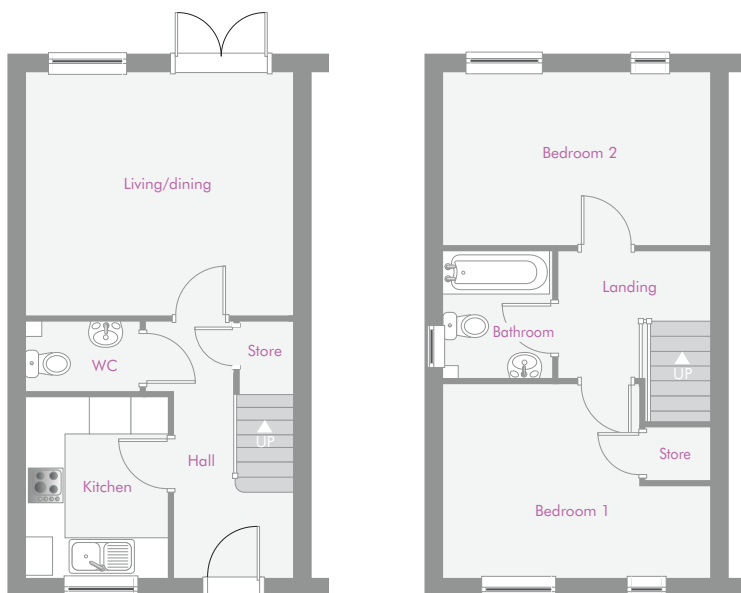

2 Bedroom Terrace House

Living/dining	4.25m x 3.93m	13'11" x 12'11"
Kitchen	2.92m x 2.28m	9'7" x 7'6"
Bedroom 1	4.25m x 3.10m	13'11" x 10'2"
Bedroom 2	4.25m x 2.82m	13'11" x 9'3"
Bathroom	2.09m x 1.74m	6'10" x 5'9"

Total Floor Area: 69.05m² - 743.29 sq.ft

Please note: All dimensions are taken from the widest and longest points of each room. Some properties will be 'handed' (mirror image) to floorplan shown.

Specification

- Fitted kitchen with oven, hob & extractor
- Bathroom with shower over bath
- Double glazed windows
- Carpets & flooring throughout
- Gas central heating
- Turfed rear garden
- Parking
- NHBC warranty

Please note: CGI's are for illustrative purposes only; external finishes including roof tile colours, brick, stone, render and landscaping may vary between plots. Properties may also be built 'handed' (mirror image) of those illustrated. Midland Heart reserves the right to alter and change certain aspects of a property – therefore it is recommended that you speak to a sales consultant for further details. All dimensions are taken from the widest and longest points of each room; they are approximate and should not be used for carpet sizes, appliance spaces and furniture. These particulars do not form part of a contract or warranty.

For further details contact
our sales team on:

0800 44 55 67

or email:

sales@midlandheart.org.uk



midland
heart

THE IVY 2 Bedroom Terrace House

Dracan Village at Drakelow Park, Burton on Trent, DE15 9UA

Site Plan



Key	Housetype - The Ivy	Plot Number
	2 Bedroom End-Terrace House	374, 376, 478, 480, 490, 493, 530, 533, 541, 543 & 548
	2 Bedroom Mid-Terrace House	375, 479, 491, 492, 531, 532, 542 & 549

For further details contact our sales team on:
0800 44 55 67 or email: sales@midlandheart.org.uk

Please note CGI's are for illustrative purposes only; external finishes including roof tile colours, brick, stone, render and landscaping may vary between plots. Properties may also be built 'handed' (mirror image) of those illustrated. Midland Heart reserves the right to alter and change certain aspects of a property – therefore it is recommended that you speak to a sales consultant for further details. All dimensions are taken from the widest and longest points of each room; they are approximate and should not be used for carpet sizes, appliance spaces and furniture. These particulars do not form part of a contract or warranty.

